



# STADIUM- CHINATOWN SKYTRAIN STATION

590 Beatty Street, Vancouver, BC

RETAIL  
LEASING BROCHURE



**NANCY BAYLY**  
Personal Real Estate Corporation  
604.628.2580  
nancy@sitings.ca

**SITINGS REALTY LTD.**  
SITINGS.CA / 604.684.6767  
1595 – 650 West Georgia Street, Vancouver, BC V6B 4N8

# PROJECT SUMMARY

Stadium-Chinatown SkyTrain Station is located in downtown Vancouver and sees approx. 28,530 riders daily. The station has 3 major access points: SE corner of Beatty St. & Dunsmuir, International Village and Pacific Blvd. The subject unit is located on the interior of the station next to Tim Horton's.

- Stadium-Chinatown Station is the closest SkyTrain station to BC Place and Rogers Arena, two major entertainment venues that host Vancouver's top professional sports teams, and concerts, tradeshows & events.
- There is a dense residential neighbourhood of over 12,000 people within 0.5 km of the site & the station will be the closest stop to the new "The Post" development, which includes a new Loblaws City Market and over 1 M SF of office including over 7,000 Amazon employees.
- Other traffic drivers in the neighborhood include International Village Mall, with a large movie theatre, and the Vancouver Community College Downtown Campus, and Costco.

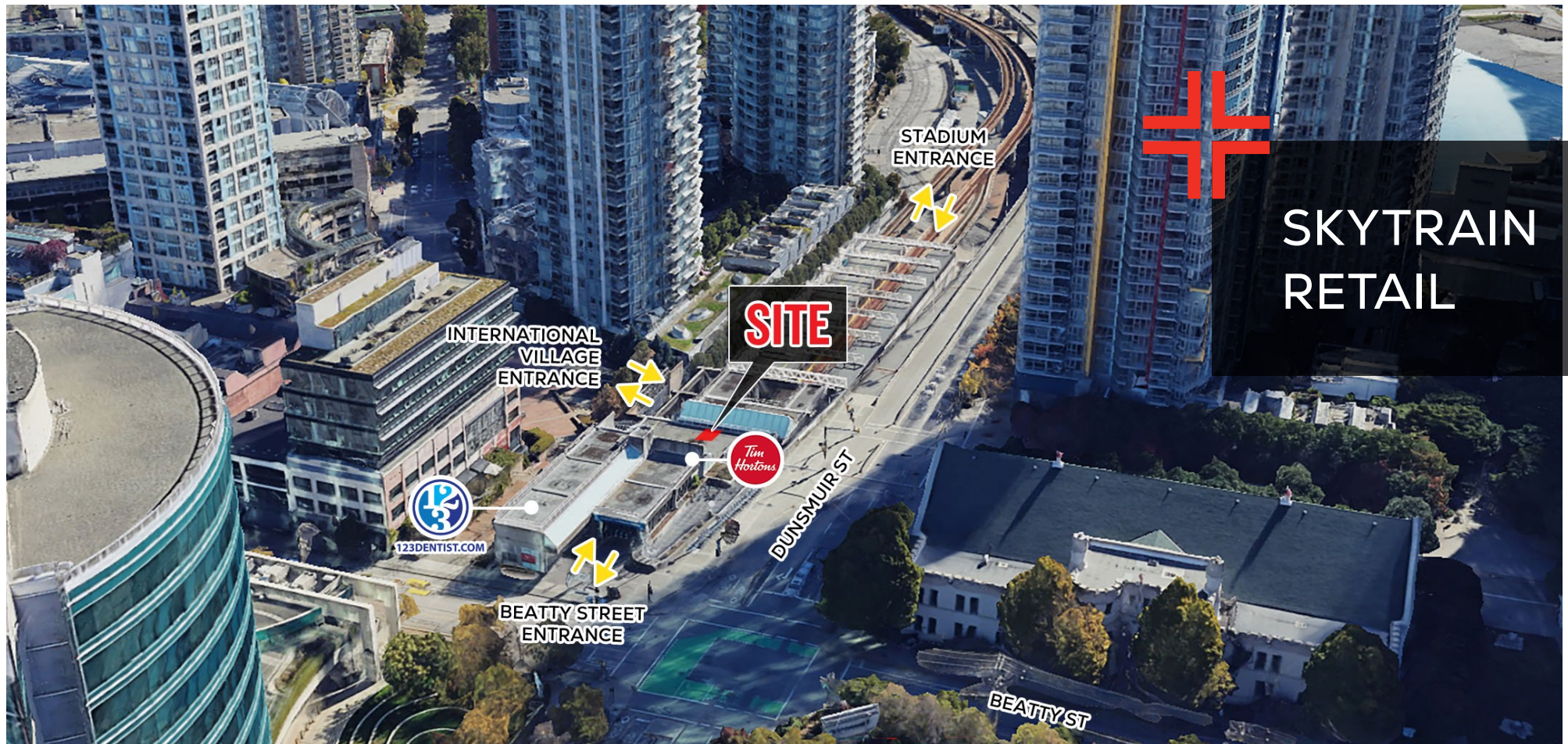

This document/email has been prepared by Sitings Realty Ltd. for advertising and general information only. Although information contained herein is from sources we believe reliable, Sitings Realty Ltd. makes no guarantees, representations or warranties of any kind, expressed or implied, regarding the information including, but not limited to, warranties of content, accuracy and reliability. This document/email is subject to errors and omissions and any interested party should undertake their own inquiries as to the accuracy of the information. Sitings Realty Ltd. excludes unequivocally all inferred or implied terms, conditions and warranties arising out of this document and excludes all liability for loss and damages arising there from. All areas, measurements and dimension herein are approximate, interested parties/tenant are to verify measurements if important to them. This document/email is not an inducement representation.

## DETAILS

✦ CRU 1: 450 SF

✦ Join Tim Hortons & 123 Dentist (Coming soon)

✦ High traffic unit with prominent signage and move in ready improvements

✦ +28,530 avg. daily rider on & off boardings. Trains run every 2-3 minutes during peak hours

 VIRTUAL TOUR

✦ Available Immediately,  
Contact Listing Agent for Rent Details

## AREA TENANTS



## CONTACT

NANCY BAYLY

Personal Real Estate Corporation  
Sitings Realty Ltd

604.628.2580  
nancy@sitings.ca

# T Key Regional Transit Connections

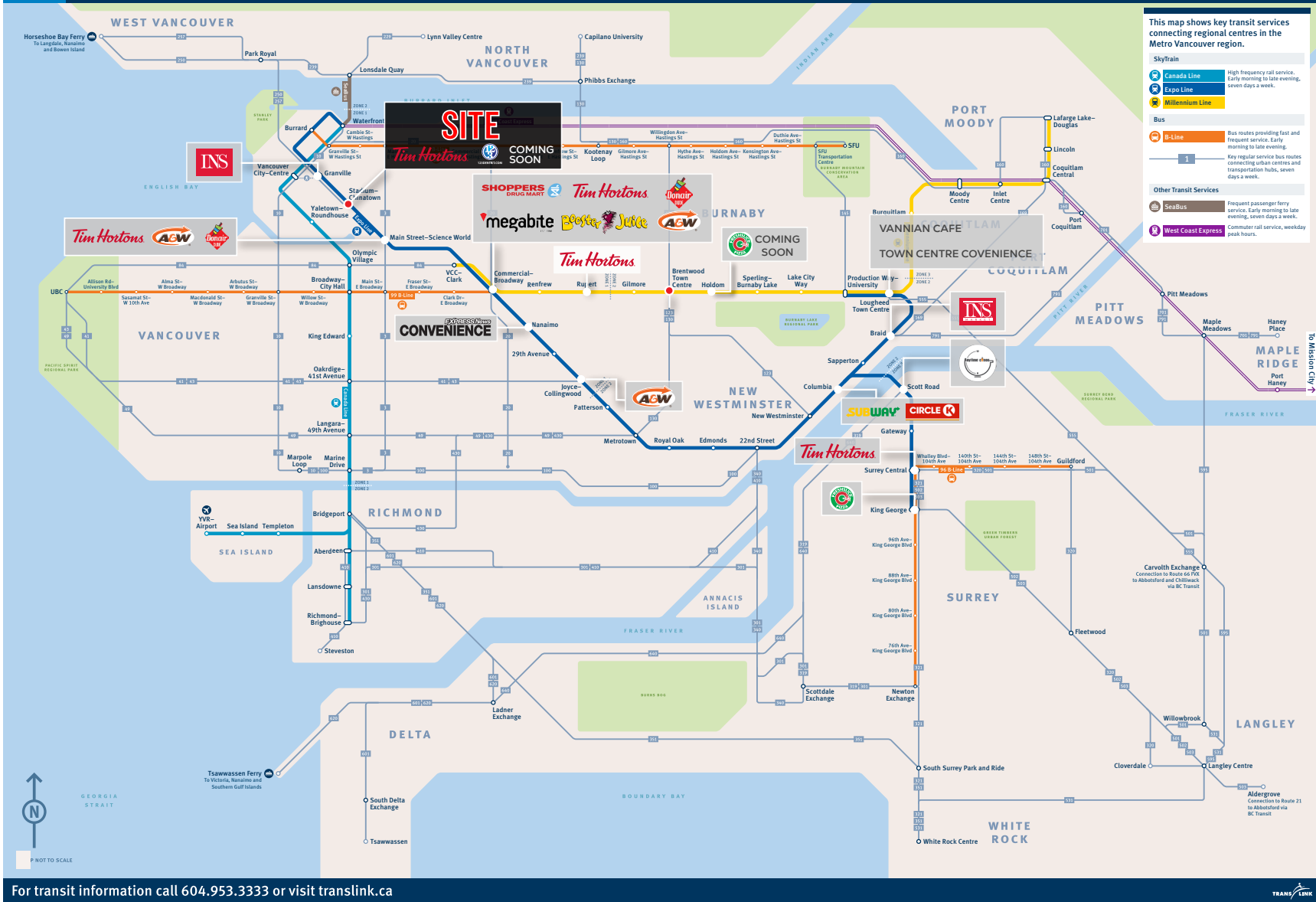

# STADIUM-CHINATOWN SKYTRAIN STATION

Vancouver, BC



**Donuts**  
**Starbucks**  
**CityMarket**  
 1M SF Office, including  
 +7,000 person Amazon office  
 185,000 SF Retail

**THE POST**  
 Commercial/Office  
 & Residential  
 Redevelopment

VANCOUVER PUBLIC LIBRARY

HAMILTON ST  
 QUEEN ELIZABETH THEATRE

VANCOUVER COMMUNITY COLLEGE  
 29000 Students

nemesis.  
 (coffee creating culture)

**BC**  
 VANCOUVER WHITECAPS FC  
 BC PLACE  
 Seating Capacity: 54,500

VANCOUVER  
 ROGERS ARENA  
 Seating Capacity: 18,360

**SITE**

BEATTY STREET ENTRANCE  
 Tim Hortons

123DENTIST.COM

THE DIRTY APRON COOKING SCHOOL

INTERNATIONAL VILLAGE ENTRANCE

大統華 T&T

STADIUM ENTRANCE

ABBOTT ST

KEEFER ST

# SITE PLAN

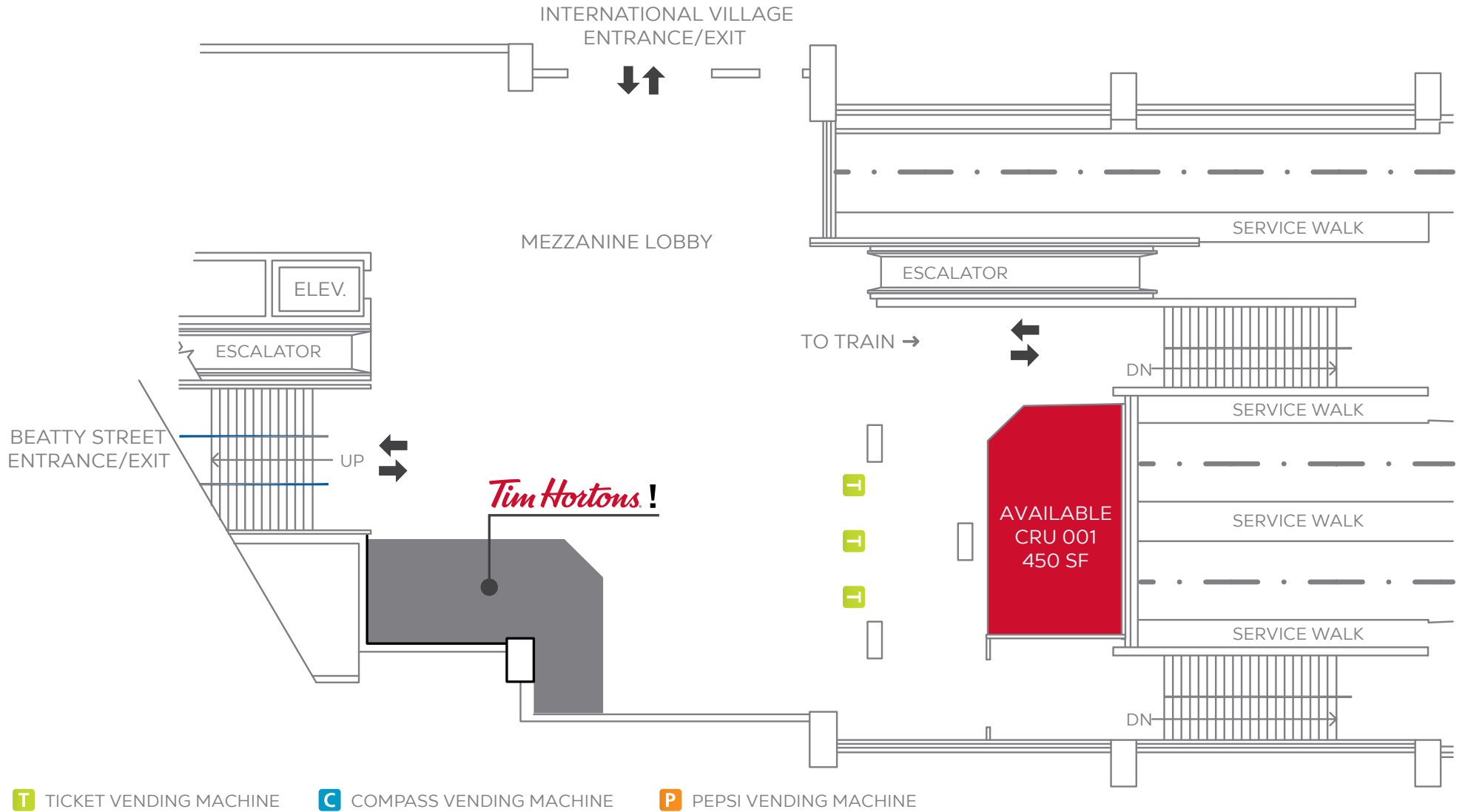





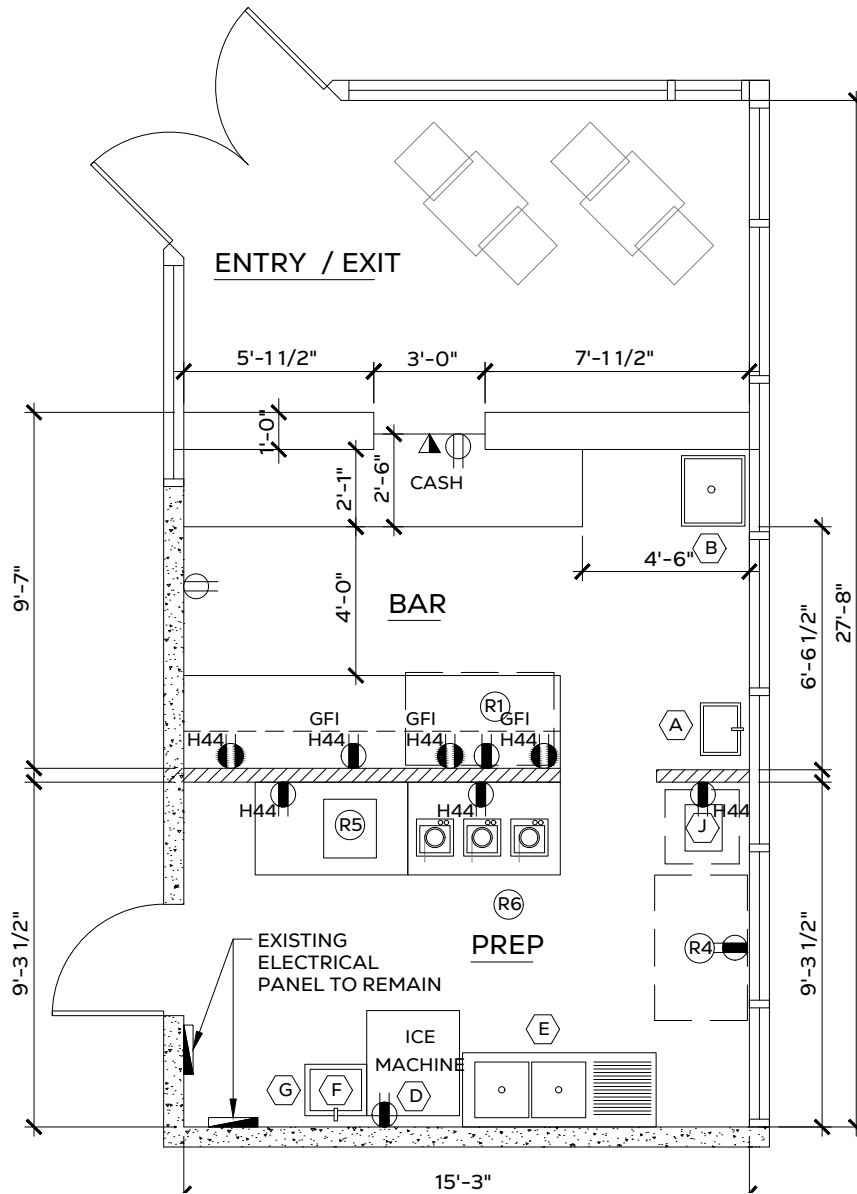

 **VIRTUAL TOUR**

# FLOOR PLAN



## VIRTUAL TOUR

-  Millwork and granite countertop with cooler insert
-  1x double basin sink
-  1x single basin sink
-  Above floor grease trap
-  Hot water tank
-  Mop sink

 VIRTUAL TOUR

